

ENGLISH

ESPAÑOL

TRUPER PRO

CORDLESS LAWN MOWER

Manual

40 V $\overline{\text{---}}$ 4 Ah

Applies for:

Code

Model

103245

PODI-40A

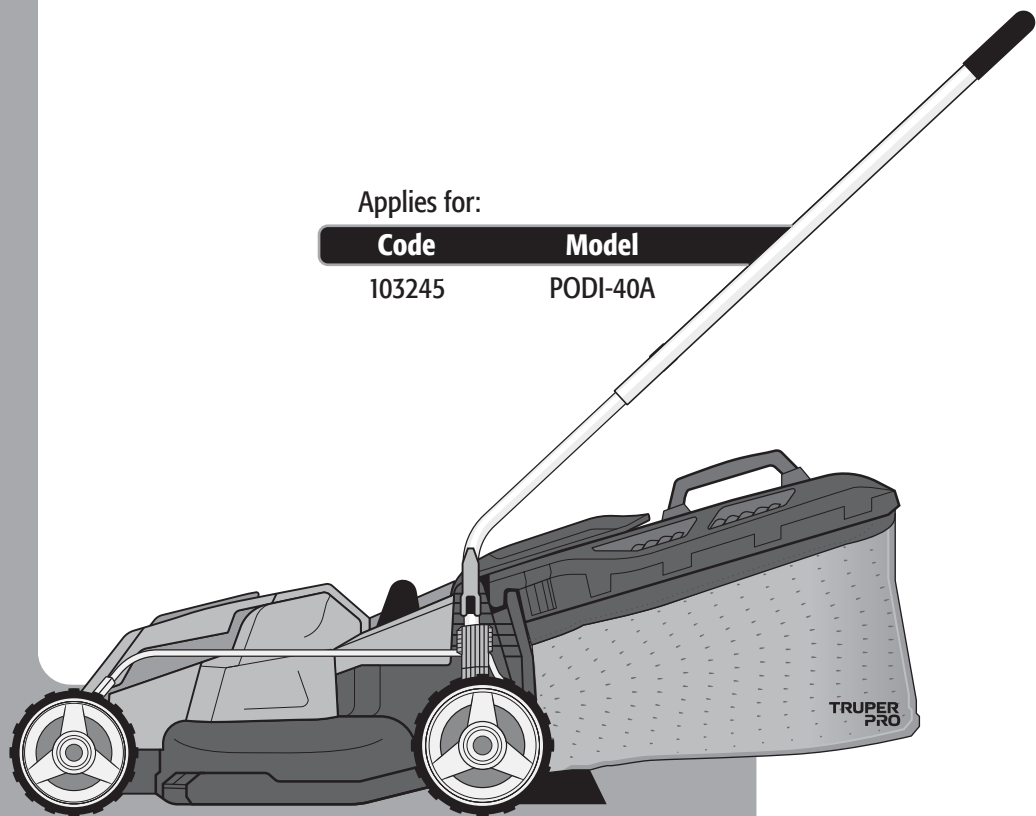

PODI-40A



CAUTION



Read this manual thoroughly
before using the tool.



Technical data	3
Power requirements	3
 General safety warnings for electric tools	4
 Safety warnings for the use of lawn mowers	5
Parts	7
Assembly	8
Start up	9
Operation	11
Maintenance	12
Troubleshooting	13
Authorized service centers	15
Warranty policy	16



CAUTION

To get the most out of the tool, extend its lifespan, claim the warranty if necessary, and avoid serious risks or injuries, please read this manual thoroughly before using the tool.

Please keep this manual for future references.

The illustrations in this manual are for reference only and may differ from the real appearance of the tool.

Use and care recommendations



Use **ONLY** the provided charger or the one suggested by TRUPER to charge the battery.



Follow the battery **GUIDELINE** for battery usage and charging (page 10).



Keep the tool and charger ventilation slots **CLEAN**.



Perform regular **MAINTENANCE** on your machine (page 12).

PODI-40A

Code	•	103245
Description	•	Lawn mower
Cutting diameter	•	13"
Voltage	•	40 V $\overline{---$ (2 x 20 V $\overline{---$)
Speed	•	4 500 RPM
Bag capacity	•	30 L
Cutting heights	•	(6 positions)
Batteries	•	20 V $\overline{---$ x2 4Ah Li-ion battery Charging time: 2.5 h approx.
Charger	•	Input: Voltage: 127 V \sim Output: 14.4 V $\overline{---$ - 20V $\overline{---$ 4 A Frequency: 60 Hz Power: 100 W

The power cable has Y-type cable clamps.
 The tool's construction class is: Basic insulation.
 The thermal insulation class of the motor windings: Class B

⚠ WARNING If the power cable is damaged, it must be replaced by the manufacturer or a TRUPER Authorized Service Center to prevent any risk of electric shock or significant accidents. The electrical insulation of this tool is altered by splashes or spillage of liquids during its operation. Do not expose it to rain, liquids, and/or moisture.



⚠ WARNING Before accessing the terminals, all power circuits must be disconnected.

Power requirements

⚠ WARNING Tools with double insulation are equipped with a polarized plug (one prong is wider than the other). This plug will only fit in the right way into a polarized outlet. If the plug cannot be introduced into the outlet, reverse the plug. If it still doesn't fit, call a qualified electrician to install for you a polarized outlet. Do not alter the plug in any way. Double insulation eliminates the need of both a grounded third power cord with three prongs or a grounded power connection.

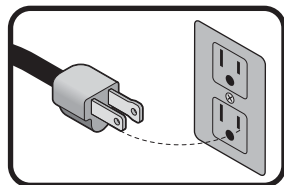

⚠ WARNING When using an extension cord, make sure to use a gauge sufficient to carry the current your tool will consume. A lower gauge cable will cause voltage drops in the line, resulting in power loss and motor overheating. The following table shows the correct size to be used depending on the cable length and the amperage capacity indicated on the tool's data plate. If in doubt, use the next higher gauge.

Capacity in Amperes	Number of conductors	Extension gaugen	
		From 6 ft (1.8m) to 49 ft (15 m)	Higher than 49 ft (15m)
from 0 to 10 A	3 (one to ground)	18 AWG (*)	16 AWG
from 10 A to 13 A		16 AWG	14 AWG
from 13 A to 15 A		14 AWG	12 AWG
from 15 A to 20 A		8 AWG	6 AWG

It is allowed to use it if the extensions themselves have an overcurrent protection device.
 AWG = American Wire Gauge. Reference: NMX-J-195-ANCE.

⚠ WARNING When operating electric tools outdoors, use a grounded extension cord marked as **VOLTECK** 'Outdoor Use'. These extensions are specially designed for outdoor use and reduce the risk of electric shock.





⚠ WARNING! Read all safety warnings, instructions, illustrations, and specifications provided with this power tool. Failure to follow all instructions listed below may result in electric shock, fire, and/or serious injury. **Keep all warnings and instructions for future reference.**

Work area

Keep your work area clean, organized, and well-lit.

Cluttered and dim areas can lead to accidents.



Do not operate the tool in explosive atmospheres, such as in the presence of flammable liquids, gas, or dust.

The electric tools produce sparks that can ignite flammable material.



Keep children and other individuals at a safe distance while using the equipment.

Distractions can cause loss of control and lead to accidents.



Electrical Safety

The tool plug must match the outlet.

Never modify a plug. Do not use any type of adapter for grounded tool plugs.

Modified plugs and different outlets increase the risk of electrical shock.



Avoid body contact with grounded surfaces such as pipes, radiators, electric stoves, and refrigerators.

There is an increased risk of electrical shock if the body is grounded.

Do not expose the tool to rain or humid conditions.

Water entering the tool increases the risk of electrical shock.

Do not force the cable. Never use the cable to transport, lift, or disconnect the tool. Keep the cable away from heat, oil, sharp edges, or moving parts.

Damaged or tangled cables increase the risk of electrical shock.

Seguridad personal

Be alert, watch what you are doing, and use common sense when handling an electrical tool. Do not use it if you are tired or under the influence of drugs, alcohol, or medication.

A moment of distraction while using the tool can cause personal injury.

Use safety equipment. Always wear eye protection.

The use of safety equipment such as safety glasses, dust mask, slip-resistant shoes, helmet, and ear protection in appropriate conditions significantly reduces the risk of personal injury.



Avoid accidental starts. Ensure the switch is in the "off" position before connecting to the power source and/or the battery or transporting the tool.

Carrying power tools with your finger on the switch or connecting power tools with the switch in the "on" position can cause accidents.

Remove any wrenches or adjusting tools before starting the power tool.

Wrenches or tools left on the rotating parts of the tool can cause personal injury.

Do not exceed your range of motion. Keep both feet firmly planted on the ground and always maintain balance.

This allows better control of the tool in unexpected situations.

Dress appropriately. Do not wear loose clothing or jewelry. Keep your hair, clothing, and gloves away from moving parts.

Loose clothes, jewelry, or long hair can get caught in moving parts.



If dust extraction and collection devices are available for the tool, check their connections and use them correctly.

The use of these devices reduces risks associated with dust.

Tool use and care

Do not force the tool. Use the appropriate tool for the task at hand.

The right tool performs better and is safer when used at the intended pace.

Do not use the tool if the switch is not functioning.

Any power tool that cannot be turned on or off is dangerous and must be repaired before operation.



Before adjusting, changing accessories, or storing the power tool, disconnect the plug from the power source, and/or remove the batteries if they are detachable.

These measures reduce the risk of accidentally starting the tool.

Store the tools out of the reach of children and do not allow them to be handled by individuals unfamiliar with the tools or their instructions.

Power tools are dangerous in untrained hands.



Maintain the tool. Ensure that the moving parts are not misaligned or jammed, and that there are no broken parts or other conditions that may affect its operation. Repair any damage before using the tool.

Many accidents are caused by inadequate tool maintenance.



Keep cutting accessories sharp and clean.

Well-maintained cutting accessories are less likely to jam and easier to control.

Use the tool, its components, and accessories in accordance with these instructions and as intended for the type of tool, in appropriate working conditions.

Using the tool for applications other than those for which it is designed could cause a hazardous situation.

Use and care of the battery-powered tool.

Only recharge with the charger specified by TRUPER.

Using the charger specified for one battery with another battery can cause a fire hazard.

Use batteries specifically designed for the tool.

Using any other battery can cause damage and fire hazard.



This tool is in compliance with the Official Mexican Standard (NOM - Norma Mexicana).

Safety warnings



for the use of lawn mowers



TRUPER PRO

Security is a combination of common sense, alertness, and knowledge of how the tool operates.

⚠ CAUTION • Carefully read the instructions before starting to use the tool. Pay attention to safety rules, alert symbols, and warnings of danger, caution, and attention in the instructions and on the labels attached to the tool.

⚠ WARNING • Remember that this pruner is designed to cut grass as indicated in this manual. It should never be used for any other purpose.

Batteries and charger

⚠ DANGER • Use only TRUPER chargers to charge the tool's battery. Using another charger may cause a fire or risk of injury.

⚠ DANGER • Use only batteries specifically designed for the tool. Other batteries may pose risks of injury or fire.

- Connect the charger only to an alternating current (AC) power supply.

⚠ DANGER • Do not use the charger outdoors.

- Respect the polarity "+/-" when charging.
- Never recharge a leaking battery.
- Do not use batteries or the charger for purposes other than those for which they were designed.
- Do not modify the battery or charger contacts.
- Never expose batteries to temperatures above 122 °F (50 °C).

⚠ DANGER • Never expose batteries to fire; they could explode.

⚠ CAUTION • The battery can be damaged by sharp objects such as nails or screwdrivers or if subjected to external force. Internal short-circuiting may occur, leading to battery ignition, smoke emission, explosion, or overheating.

⚠ CAUTION • Do not open the battery. There is a risk of short circuiting. Protect the battery from heat, intense continuous sunlight, fires, water, and moisture.

⚠ DANGER • Explosion hazard. In case of battery damage and improper use, vapors may be emitted. Ventilate the area and seek medical attention if you feel unwell. Vapors can irritate the respiratory system.

⚠ CAUTION • To maximize battery life, discharge it completely at least once a month. Do not leave the battery uncharged for more than three months. Always charge the battery to its maximum capacity. Before using the machine for the first time, charge the batteries for a minimum of 2.5 hours.

⚠ CAUTION • When batteries are in use, keep them away from metallic objects such as clips, coins, keys, hardware, or any object that may make a connection between the terminals.



- A short circuit between the terminals can cause burns or fire.
- Under severe conditions, battery liquid may spill; avoid contact. If there is accidental contact, wash the area with water. If there is contact with the eyes, seek medical help.

- Spilled liquid can cause irritation or burns.
- Avoid constantly stopping while operating the tool to prevent battery damage.
- Do not throw batteries into the fire. The cell may explode. Consult local codes for possible special disposal instructions.
- Do not open or mutilate batteries. The electrolyte released is corrosive and can cause eye or skin damage. It can be toxic if ingested.
- Do not charge batteries in the rain or in damp places.

Before operating the tool

- Do not use the tool in the rain or under humid conditions. The electric motor is not waterproof.
- Novice users should be trained by an experienced user on how to use the tool.
- The tool should not be used by children or individuals under 18 years of age. Individuals over 16 years old may use it if they receive training under expert supervision.

⚠ DANGER • Never use the tool when tired, ill, or under the influence of drugs, alcohol, or medication.

⚠ CAUTION • Equip yourself with appropriate clothing to operate the tool: tight-fitting clothing, thick pants, slip-resistant safety boots, heavy-duty protective gloves, and safety glasses with side protection according to ANSI Z87.1.

- Ensure that the tool is in perfect condition to use safely. Do not turn it on if it is poorly adjusted, not fully assembled, or has any loose screws.
- Check the work area and remove any stones, glass, nails, wire, rope, or any foreign objects. They could be thrown or tangled in the tool.
- Ensure that visibility and lighting conditions are adequate for clear vision; otherwise, do not use the tool.
- This device is not intended for use by individuals (including children) whose physical, sensory, or mental capabilities are different or impaired, or who lack experience or knowledge, unless they receive supervision or training for the operation of the device from a person responsible for their safety.
- Children should be supervised to ensure that they do not use the devices as toys.



Before using the lawnmower

⚠ CAUTION • Thoroughly inspect the area to be mowed to avoid any obstacles and remove foreign objects that may be tripped over or thrown by the lawnmower blade. Otherwise, it may cause a serious accident and/or reduce the lawnmower's lifespan.

⚠ CAUTION • The area to be trimmed must be well-lit.

⚠ CAUTION • Ensure that the lawnmower has all its parts in optimal condition and that its guard and accessories are properly installed. Check that the ventilation slots are free of debris. Do not use the lawnmower if the guard is damaged or if it is missing any parts.

⚠ WARNING • Establish a pruning pattern that avoids dumping waste material on the side of streets, sidewalks, pedestrians, etc. Do not discharge material against a wall or obstruction. This could cause discharged material to bounce back at the operator.

• While mowing, always wear sturdy shoes and long pants. Do not operate the equipment barefoot or with open sandals.

While using the lawnmower

⚠ WARNING • To avoid contact with the blade or injuries caused by a thrown object, stay behind the lawnmower, and keep children and pedestrians at least 50 ft (15 m) away during its operation. Immediately stop the engine if someone enters the mowing area. Never use the lawnmower near people, children, or pets. Do not allow children or untrained personnel to operate the lawnmower.

⚠ CAUTION • Always use appropriate eye protection to protect your eyes when using the lawnmower or adjusting or repairs. Always wear a mask if using the lawnmower in dusty conditions. Do not wear loose clothing or jewelry that can be caught in moving parts. Protective gloves and safety footwear are recommended.

⚠ CAUTION • Do not drive over gravel paths with the engine running; the cutting blade can throw gravel fragments at the operator or others.

⚠ WARNING • Do not approach the cutting head with your hands or feet while the lawnmower is running. Contact with the blade can result in the amputation of a limb.

⚠ CAUTION • Do not attempt to adjust the wheels or cutting height while the engine is running; turn it off and wait for the blade to come to a complete stop.

- If the lawnmower starts to vibrate excessively, stop the engine, and immediately look for the cause. Excessive vibration usually indicates a problem; refer to the troubleshooting section for solutions.

⚠ WARNING • Many of the accidents that occur during lawnmower operation are due to slips or trips by the operator, leaving feet or hands exposed to the cutting head. To minimize this risk:

- Thoroughly inspect the area to be mowed to avoid any obstacles such as potholes, furrows, rocks, hidden objects, or mounds; and remove foreign objects that may cause tripping.

- Do not use the lawnmower with bare feet or with sandals or lightweight shoes; safety footwear is recommended.

- Do not try to hold onto the lawnmower if you trip; release the handle immediately to stop the blade.

- Never pull the lawnmower toward you while walking. If you need to back up the lawnmower to avoid any obstacles, first look down and behind to avoid tripping, then step away from the lawnmower until your arms are fully extended. With both feet firmly on the ground and your body well balanced, slowly pull the lawnmower towards you.

- Do not mow grass near cliffs, ditches, or embankments as you could lose balance.

- Do not mow grass on slopes with an angle greater than 15°, meaning they have an elevation of approximately 75 m (246 ft) every 3 m (9.8 ft). Mow across a slope and never uphill or downhill and be very careful when changing direction on the slope.

- Do not mow wet or damp grass, as it could make you slip.

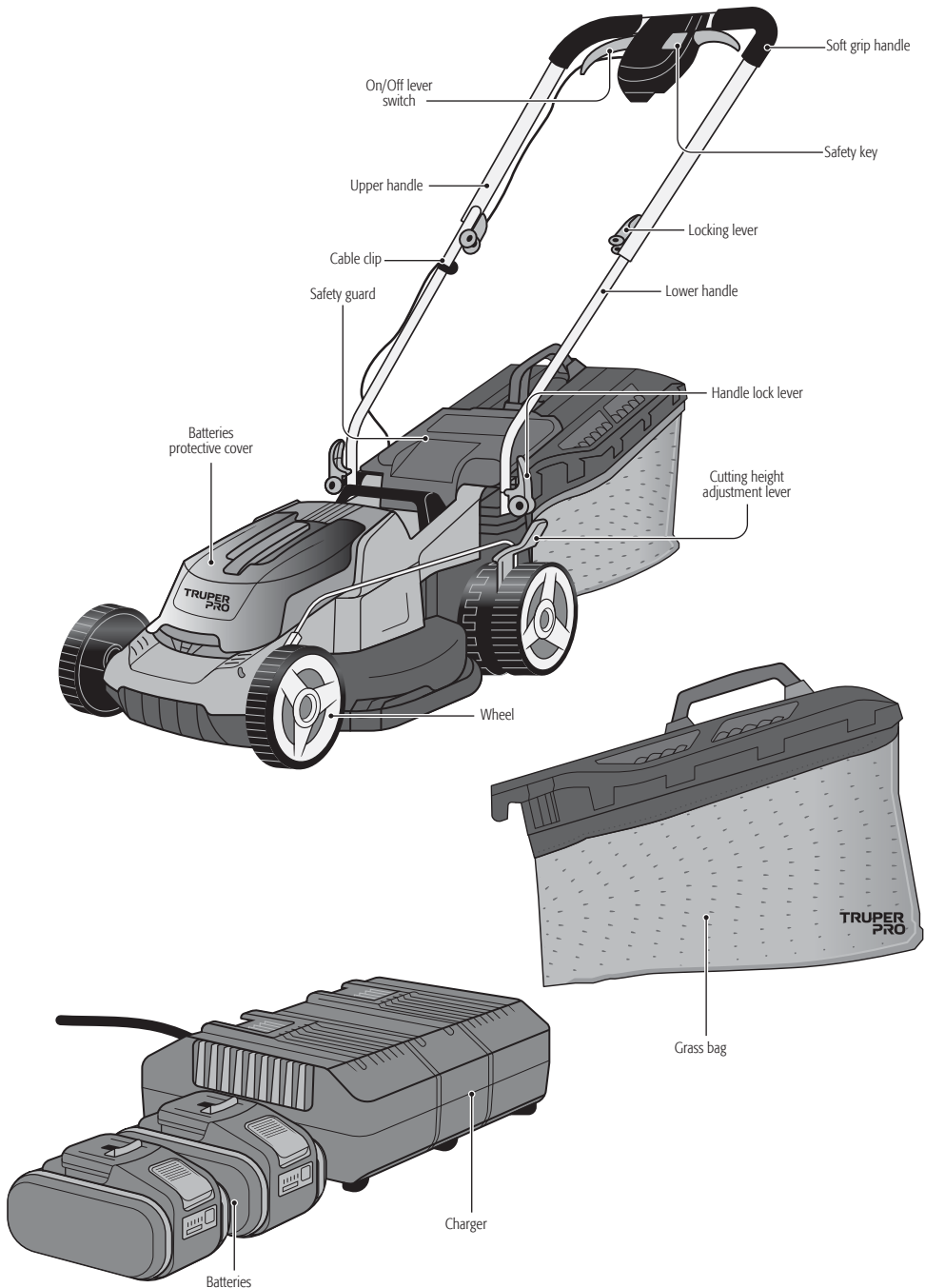

Handle Installation.

- Turn the locking lever (C1) of the platform counterclockwise to remove it.
 - Insert the lower handle into the platform slot (A) by passing the mounting bolt through the handle hole (B).
 - Place the locking plate (C1) with its washer on the mounting bolt and turn until the assembly is properly secured as indicated in (G).
 - Repeat the same steps for the other side of the lower handle.
 - Remove the locking lever from the other end of the lower handle.
 - Connect the lower handle to the upper handle aligning the holes to insert the mounting bolt as indicated in image (D).
 - Tighten the locking lever of the upper handle by pressing the lever onto the lower handle, as shown in (E).
 - Repeat the same steps on the other side of the upper handle. Ensure that the handles are fully secured.
 - Place the provided cable clips on the upper and lower handles. Insert the cable into the clips to secure it to the handle, making sure there is enough slack in the cable. (F)
- ⚠ CAUTION** • Make sure the cable is routed underneath the lower handle.

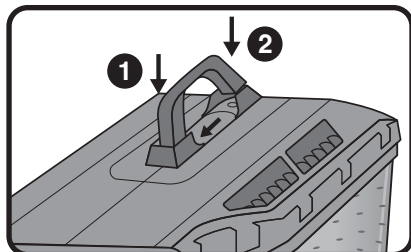
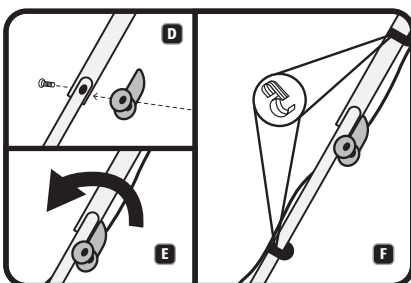
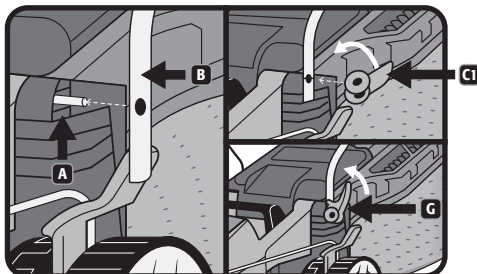
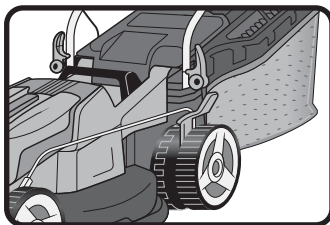

Collection bag assembly

- Assemble the handle on top of the box. Align the front and back parts of the handle with the front and back slots of the grass collection bag. Insert the front part of the handle 1 while pressing the back part of the handle 2 until you hear a click.
- To mount it, open the safety guard. Lift the collection bag by the handle and place it on the upper hooks of the lawnmower (3, 4).

⚠ CAUTION Press the collection bag lightly to ensure it is fully installed.

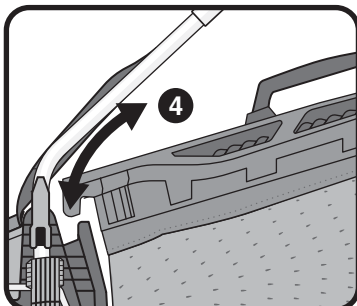
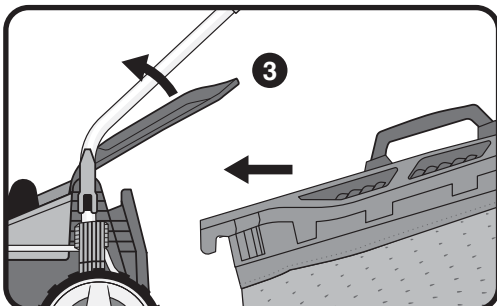

On and Off

- Insert the safety key into the engine switch on the top of the main handle.
- Slide the key in the indicated direction on key **1**. Pull the switch lever towards handle **2** and the mower will start.
- Release the safety key while holding the switch lever.

CAUTION The switch levers do not lock. Hold them firmly against the handle throughout the work period.

CAUTION To stop the lawnmower, release both switch levers.

CAUTION Wait for the mower to come to a complete stop. Remove the safety key.

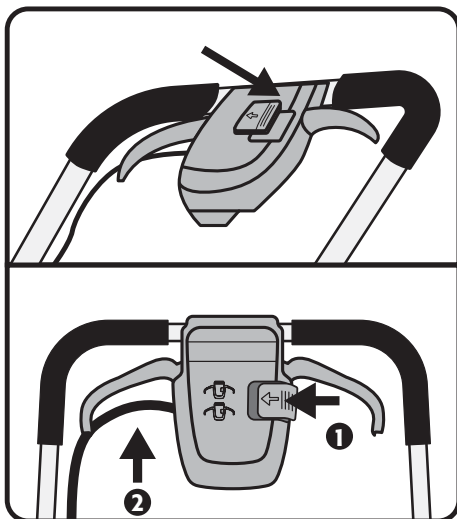

Adjusting the Cutting Height

- The lawnmower is delivered set in a low cutting position. Before using it for the first time, adjust the cutting position to the most convenient height for your grass.
- To raise the blade height, **1** lightly pull the adjustment lever and **2** slide it towards the front of the lawnmower to achieve the desired cutting height.
- To lower the blade height, move the height adjustment lever towards the back of the lawnmower.

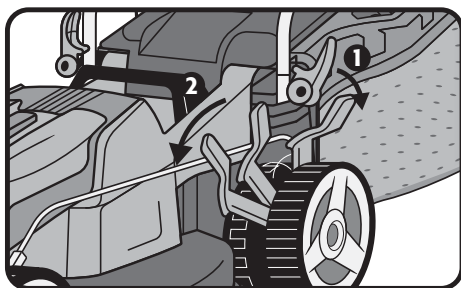

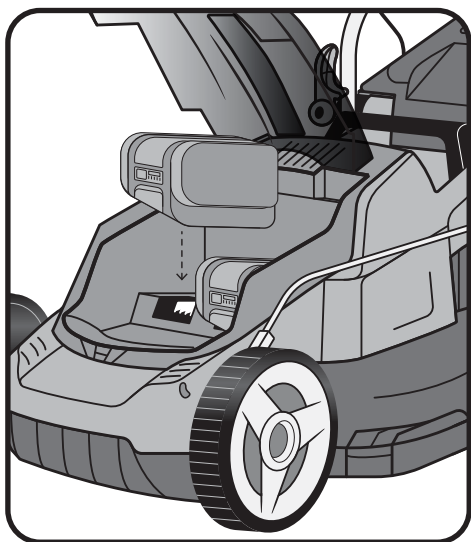

Battery Installation or Removal

To install the batteries:

- Lift the protective cover of the battery compartment.
- Insert each battery into the receptacle and push until you hear a click.
- To remove the batteries:
- Press the battery release button and pull to remove the batteries from the tool. After charging them, insert the batteries into the tool's battery ports.

⚠ CAUTION Do not use any charger other than the one specifically provided for use with the equipment.

⚠ CAUTION If the battery is very hot, remove it from the charger and allow it to cool before recharging.

⚠ CAUTION The battery in your new tool is not charged when it leaves the factory. Therefore, it must be fully charged before using it for the first time.

⚠ CAUTION Charge the battery to full or at least half before storing it. If the tool will not be used for long periods, charge the battery every 3-6 months.

Charging instructions

- Plug the charger into a suitable power outlet.
- Insert each battery into the charging port. Typically, the corresponding charging indicator will flash in green, indicating that the battery is charging.

⚠ WARNING • When the battery charge is depleted after continuous use or direct exposure to sun or heat, allow the battery to cool before recharging it to achieve full charge.

Emptying the collection bag

- Release both switch levers and wait for the blade to come to a complete stop.
- Lift the rear guard and the collection bag by the handle to remove it from the lawnmower.
- Dispose of the grass clippings.
- Lift the rear flap and reattach the collection bag as described on page 8.
- Empty the collection bag once it is full or when the job is done. Do not store it filled with grass clippings to avoid mold or fire hazard.
- The pores of the collection bag material can become blocked by debris or dirt, making grass collection difficult. To prevent this situation, regularly wash the bag with a hose and let it dry before mounting it on the lawnmower.
- The collection bag has a filling indicator valve (A) on the top of the bag, which allows you to quickly see when the bag reaches its maximum level and needs to be emptied.

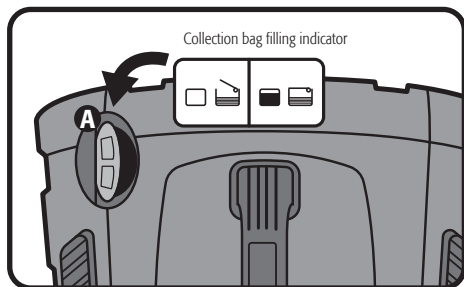

- Adjust the lawnmower to the desired cutting height.
- Turn on the lawnmower on level ground.
- Push the lawnmower by the handle to cut the grass; never pull it, as it exposes the blade to your feet.
- Do not mow the grass in circles; do it in straight lines from one end to the other of the mowing area. When you reach one end, turn the lawnmower by pushing the handle down so that the front wheels lift and you can use the rear wheels as a pivot to turn the lawnmower. Push the lawnmower back, overlapping the mowed gaps.

⚠ WARNING It's important that you always stay at the back of the lawnmower holding the handle without getting close to the cutting head.

- Do not mow the grass quickly; push the lawnmower slowly and firmly at a steady pace.

⚠ WARNING • Never attempt to mow the grass in reverse; always do it forward.

- If working near traffic lanes, mow facing the traffic.
- Turn off the lawnmower when moving it from one place to another.
- If you hit an unexpected obstacle, turn off the lawnmower and wait for the blade to come to a complete stop. Inspect carefully if the lawnmower was damaged. Repair any damage before using it again.

Recommendations

- When cutting thick grass, mow more slowly to achieve a better cut and proper clippings discharge. For a healthy lawn, always cut one-third or less of its total height.
- When mowing very tall grass, do it in two passes with the lawnmower. First, set the cutting height to the highest position and make the first cut; then adjust the cutting height to the final position needed for the grass and make the second cut.
- To ensure effective mulching, do not mow wet grass as it tends to stick to the inner face of the guard and does not get mulched properly.
- New or dense grass may require a lower cut.
- Do not cut more than 1/3 of the total grass length in each pass.

Mowing on slopes

⚠ WARNING • Mowing grass on slopes requires special considerations; failure to follow them can result in a serious accident.

- Never operate the lawnmower on slopes of more than 15°, or, for practical purposes, with a maximum elevation of 1 m (3.28') for every 4 m (13.12'). Otherwise, it could slip or lose control of the lawnmower, and it could even tip over, exposing the moving blade towards you. Use the chart below as a reference to determine if the slope you are mowing is safe or not.

- Stand to the side of the slope.
- Fold the instruction manual in half.
- Hold it in front of you with your arm extended.
- Align the left margin with a straight tree, wall, post, or any vertical reference.
- Compare the slope angle with the chart to check if it's safe or not to use the lawnmower.

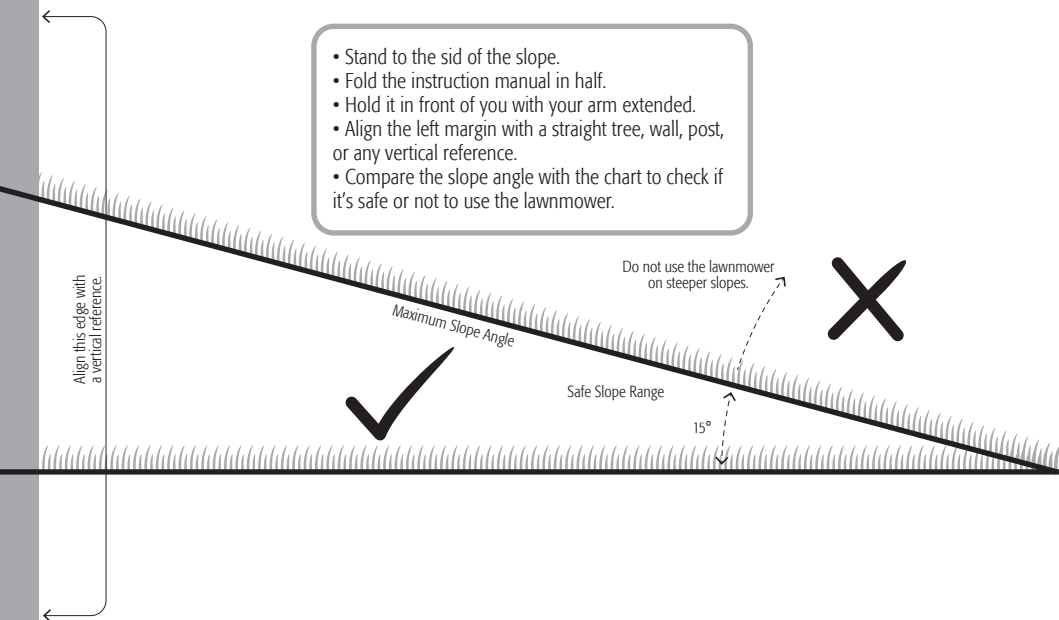

⚠ CAUTION • Regular and careful maintenance is essential to maintain optimal safety levels and performance of the lawnmower.

- Keep nuts, bolts, and screws tightened to ensure the lawnmower is in a safe working condition.

⚠ CAUTION • Keep the blade sharp and clean. Be very careful when doing so, the edge could cut you if you don't use proper protection. Use padded leather safety gloves from TRUPER.

- The grass catcher bag and rear discharge chute are subject to wear and tear, inspect them regularly and replace if damaged, otherwise you risk meeting moving parts or allowing objects to be ejected by the blade force.

- Do not alter safety devices. Check their proper functioning regularly.

- Any worn or damaged part should be replaced before using the lawnmower. Do not attempt to repair parts, as this could damage the lawnmower and jeopardize your safety.

- Due to the abrasive action of cut grass, the underside of the lawnmower may become damaged over time. The handle and all metal parts may show damage to the coating, if so, touch up the deteriorated areas immediately using anti-corrosive paint to prevent rust formation.

- When servicing the blade, remove the batteries and secure the blade to prevent involuntary movement.

Cleaning

- Cleaning the lawnmower after each use will keep it in optimal condition and prolong its lifespan, preventing rust and corrosion.

- To remove mud, grass, and leaves buildup inside and outside the lawnmower, use compressed air, a cloth, and a soft brush.

- Make sure to clear any obstructions from the motor air intakes.

- Remove all debris from inside the lawnmower before it dries, or it may be difficult to start next time you try to use it.

- Clean the underside of the lawnmower after each use.

Storage

- Turn off the lawnmower: remove the safety key.

- Remove the batteries.

- Allow the engine to cool down.

- Loosen the upper handle locking lever and fold the handlebar.

- Apply a thin layer of oil or silicone to all metal parts to protect them from corrosion.

- Store the lawnmower in a dry, clean place protected from frost. Cover it with a breathable tarp to protect it from dust. Do not use plastic wrap to avoid moisture buildup.

Blade Replacement

- Use padded leather safety gloves from TRUPER.

- Wedge a wooden block between the blade and the guard to prevent the blade from turning.

- Use a socket or a 19 mm wrench to loosen the nut securing the blade by turning it counterclockwise.

- Remove the nut, washer, and blade.

- After sharpening the blade or replacing it with a new one, install it by mounting all parts in the same order as when you disassembled them.

- If replacing the blade, also replace the screw.

- Remember that a sharp blade will greatly improve the performance of the lawnmower, especially when cutting tall grass. Check and sharpen the blade at least once a year.

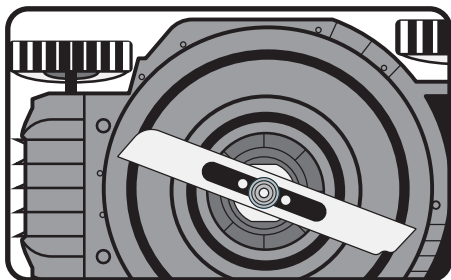

Problem

Solution

The lawnmower does not operate when the switch lever is activated.

- Check that the safety key has been installed and is fully in place, and that the switch lever is being pressed down completely.
- Release the switch lever to turn off the lawnmower. Remove the safety key, turn the lawnmower over, and check that the blade can spin freely. If it doesn't, take the lawnmower to an authorized service center. The blade should spin freely.
- Have the batteries been fully charged? Plug in the charger and wait for the green light to turn on.

The motor stops while cutting grass.

- Release the switch lever to turn off the lawnmower. Remove the safety key, turn the lawnmower over, and check that the blade can spin freely. If it doesn't, take the lawnmower to an authorized service center. The blade should spin freely.
- Raise the cutting height of the wheels to the highest position and turn on the lawnmower.
- Have the batteries been fully charged? Plug in the charger and wait for the green light to turn on.
- Avoid overloading the lawnmower. Reduce cutting speed by pushing the lawnmower more slowly or increase the cutting height. Or both.

The lawnmower runs, but the cutting performance is unsatisfactory, or it does not cut all the grass.

- Have the batteries been fully charged? Plug in the charger and wait for the green light to turn on.
- Release the switch lever to turn off the lawnmower. Remove the safety key. Turn the mower over and check: Blade to see if it's sharp: keep the blade sharp. Cover and discharge chute for obstructions.
- The wheel height adjustment may be too low for the grass condition. Increase the cutting height.

The lawnmower is too difficult to push.

- Increase the cutting height to reduce deck resistance on the grass. Ensure each wheel spins freely.

The lawnmower makes abnormal noise and vibrates.

- Release the power lever to turn off the lawnmower. Remove the safety key. Tilt the lawnmower and check the blade to ensure it is not bent or damaged. If the blade is damaged, replace it with a spare blade. If the underside of the deck is damaged, take the lawnmower to an authorized service center.
- If there is no visible damage to the blade and the lawnmower still vibrates: release the power lever to turn off the lawnmower, remove the safety key, and remove the blade. Rotate the blade 180 degrees and tighten it again. If the lawnmower still vibrates, take it to a TRUPER Authorized Service Center.

The battery charger LED light is not on.

- Check the plug connection.
- Replace the charger.

The battery charger LED light does not change to green.

- The battery needs checking. Take it to an authorized center.

The lawnmower does not collect shredded grass with the collection bag.

- Obstructed chute. Release the power lever to turn off the lawnmower. Remove the safety key. Clean the clippings chute.
- Too much cut grass. Adjust the wheel cutting height to shorten the cut length.
- Full bag. Empty the bag more frequently.

Problem

Solution

Debris is observed during shredding.

- Too much grass cut. Adjust the wheel cutting height to shorten the cut length. Do not cut more than 1/3 of the total length.
- Check the sharpness of the blade. Always keep the blade sharp.

Low or decreased runtime after many uses.

- Return to an authorized service center; new batteries may be needed.

The battery charger LED light flashes in red, and the batteries cannot be charged.

- The batteries overheat after continuous use. Remove the batteries from the charger and allow them to cool to 107°F or below.

The battery is briefly hot and smoking, then does not charge or discharge.

- In this situation, turn off the tool and remove the battery. You will need a new battery for your tool.

Warning symbols

 **CAUTION:**
Read the instructions



 **CAUTION:**
Do not stand beside the lawnmower



 **CAUTION:**
Do not insert hands into the cutting area



 **CAUTION:**
Use hearing protection



In the event of any problem contacting a Service Center, please see our webpage WWW.TRUPER.COM to get an updated list, or call our toll-free numbers 800 690-6990 or 800 018-7873 to get information about the nearest TRUPER Authorized Service Center.

AGUASCALIENTES	DE TODO PARA LA CONSTRUCCIÓN GRAL. BARRAGÁN #1201, COL. GREMIAL, C.P. 20030, AGUASCALIENTES, AGS. TEL.: 449 994 0537	MORELOS	FIX FERRETERÍAS CAPITAN ANZURES #95, ESQ. JOSÉ PERDIZ, COL. CENTRO, C.P. 62740, CUAUTLA, MOR. TEL.: 735 352 8931
BAJA CALIFORNIA	SUCURSAL TIJUANA AV. LA ENCHANTADA, LOTE #5, PARQUE INDUSTRIAL EL FLORIDO II, C.P. 22244, TIJUANA, B.C. TEL.: 664 969 5100	NAVARIT	HERRAMIENTAS DE TEPIC MAZATLAN #117, COL. CENTRO, C.P. 63000, TEPIC, NAY. TEL.: 311 258 0540
BAJA CALIFORNIA SUR	FIX FERRETERÍAS FELIPE ÁNGELES ESQ. RUIZ CORTÍNEZ S/N, COL. PUEBLO NUEVO, C.P. 23670, CD. CONSTITUCIÓN, B.C.S. TEL.: 613 132 1115	NEUVO LEÓN	SUCURSAL MONTERREY CARRETERA LAREDO #300, 1B MONTERREY PARKS, COLONIA PUERTA DE ANAHUAC, C.P. 66052, ESCOBEDO, NUEVO LEÓN, TEL.: 81 8352 8791 / 81 8352 8790
CAMPECHE	TORNILLERÍA Y FERRETERÍA AAA AV. ALVARO OBREGÓN #324, COL. ESPERANZA C.P. 24080 CAMPECHE, CAMP. TEL.: 981 815 2808	OAXACA	FIX FERRETERÍAS AV. 20 DE NOVIEMBRE #910, COL. CENTRO, C.P. 68300, TUXTEPEC, OAX. TEL.: 287 106 3092
CHIAPAS	FIX FERRETERÍAS AV. CENTRAL SUR #27, COL. CENTRO, C.P. 30700, TAPACHULA, CHIS. TEL.: 962 118 4083	PUEBLA	SUCURSAL PUEBLA AV. PERIFÉRICO #2-A, SAN LORENZO ALMECATLA, C.P. 72710, CUAUTLACINGO, PUE. TEL.: 222 282 8282 / 84 / 85 / 86
CHIHUAHUA	SUCURSAL CHIHUAHUA AV. SILVESTRE TERRAZAS #128-11, PARQUE INDUSTRIAL BAFAR, CARRETERA MÉXICO CUAUHTÉMOC, C.P. 31415, CHIHUAHUA, CHIH. TEL.: 614 434 0052	QUERÉTARO	ARU HERRAMIENTAS S.A. DE C.V. AV. PUERTO DE VERACRUZ #110, COL. RANCHO DE ENMEDIO, C.P. 76842, SAN JUAN DEL RÍO, QRO. TEL.: 427 268 4544
CIUDAD DE MÉXICO	FIX FERRETERÍAS EL MONSTRUO DE CORREGIDORA, CORREGIDORA # 35, COL. CENTRO, C.P. 06060, CUAUHTÉMOC, CDMX. TEL.: 55 5522 5031 / 5522 4861	QUINTANA ROO	FIX FERRETERÍAS CARRETERA FEDERAL MZ. 46 LT. 3 LOCAL 2, COL. EJIDAL, C.P. 77710 PLAYA DEL CARMEN, Q.R. TEL.: 984 267 3140
COAHUILA	SUCURSAL TORREÓN CALLE METAL MECÁNICA #280, PARQUE INDUSTRIAL ORIENTE, C.P. 27278, TORREÓN, COAH. TEL.: 871 209 68 23	SAN LUIS POTOSÍ	FIX FERRETERÍAS AV. UNIVERSIDAD #1850, COL. EL PASEO, C.P. 78320, SAN LUIS POTOSÍ, S.L.P. TEL.: 444 822 4341
COLIMA	BOMBAS Y MOTORES BYMTESA DE MANZANILLO BLVD. MIGUEL DE LA MADRID #190, COL. 16 DE SEPTIEMBRE, C.P. 28239, MANZANILLO, COL. TEL.: 314 332 1986 / 332 8013	SINALOA	SUCURSAL CULIACÁN AV. JESÚS KUMATE SUR #4301, COL. HACIENDA DE LA MORA, C.P. 80143, CULIACÁN, SIN. TEL.: 667 173 9139 / 173 8400
DURANGO	TORNILLOS ÁGUILA, S.A. DE C.V. MAZURIO #200, COL. LUIS ECHEVERRÍA, DURANGO, DGO. TEL.: 618 817 1946 / 618 818 2844	SONORA	FIX FERRETERÍAS CALLE 5 DE FEBRERO #517, SUR LT. 25 MZ. 10, COL. CENTRO, C.P. 85000, CD. OBREGÓN, SON. TEL.: 644 413 2392
ESTADO DE MÉXICO	SUCURSAL CENTRO JILOTEPEC PARQUE INDUSTRIAL # 1, COL. PARQUE INDUSTRIAL JILOTEPEC, JILOTEPEC, EDO. DE MÉX. C.P. 54257 TEL.: 761 782 9101 EXT. 5728 Y 5102	TABASCO	SUCURSAL VILLAHERMOSA CALLE HELIO LOTES 1, 2 Y 3 MZ. #1, COL. INDUSTRIAL, 2A ETAPA, C.P. 86010, VILLAHERMOSA, TAB. TEL.: 993 553 7244
GUANAJUATO	CÍA. FERRETERA NUEVO MUNDO S.A. DE C.V. AV. MÉXICO - JAPÓN #225, CD. INDUSTRIAL, C.P. 38010, CELAYA, GTO. TEL.: 461 617 7578 / 79 / 80 / 88	TAMAULIPAS	VM ORINGS Y REFACCIONES CALLE ROSITA #527 ENTRE 20 DE NOVIEMBRE Y GRAL. RODRÍGUEZ, FRACC. REYNOSA, C.P. 88780, REYNOSA, TAMS. TEL.: 899 926 7552
GUERRERO	CENTRO DE SERVICIO ECLIPSE CALLE PRINCIPAL MZ.1 LT. 1, COL. SANTA FE, C.P. 39010, CHILPANCINGO, GRO. TEL.: 747 478 5793	TLAXCALA	SERVICIOS Y HERRAMIENTAS INDUSTRIALES PABLO SIDAR #132, COL. BARRIO DE SAN BARTOLOMÉ, C.P. 90970, SAN PABLO DEL MONTE, TLAX. TEL.: 222 271 7502
HIDALGO	FERREPRECIOS S.A. DE C.V. LIBERTAD ORIENTE #304 LOCAL 30, INTERIOR DE PASAJE ROBLEDO, COL. CENTRO, C.P. 43600, TULANCINGO, HGO. TEL.: 775 753 6615 / 775 753 6616	VERACRUZ	LA CASA DISTRIBUIDORA TRUPER BLVD. PRIMAVERA, ESQ. HORTENSIA S/N, COL. PRIMAVERA C.P. 93308, POZA RICA, VER. TEL.: 782 823 8100 / 826 8484
JALISCO	SUCURSAL GUADALAJARA AV. ADOLFO B. HORN # 6800, COL. SANTA CRUZ DEL VALLE, C.P.: 45655, TLAJOMULCO DE ZUNIGA, JAL. TEL.: 33 3606 5285 AL 90	YUCATÁN	SUCURSAL MÉRIDA CALLE 33 #600 Y 602, LOCALIDAD ITZINCAB Y MULSAV, MPIO. UMAN, C.P. 97390, MÉRIDA, YUC. TEL.: 999 912 2451
MICHOACÁN	FIX FERRETERÍAS AV. PASEO DE LA REPÚBLICA #3140-A, COL. EX-HACIENDA DE LA HUERTA, C.P. 58050, MORELIA, MICH. TEL.: 443 334 6858		

Code	Model	Brand
103245	PODI-40A	TRUPER PRO

Warranty. Duration: 3 year. Coverage: parts, components and workmanship against manufacturing or operating defects, except if used under conditions other than normal; when it was not operated in accordance with the instructive; was altered or repaired by personnel not authorized by TRUPER®. To make the warranty valid, present the product, stamped policy or invoice or receipt or voucher, in the establishment where you bought it or in Corregidora 35, Centro, Cuauhtémoc, CDMX, 06060, where you can also purchase parts, components, consumables and accessories. It includes the costs of transportation of the product that derive from its fulfillment of its service network. Phone number 800-018-7873. Made in China. Imported by TRUPER, S.A. de C.V. Parque Industrial 1, Parque Industrial Jilotepec, Jilotepec, Edo. de Méx. C.P. 54257, Phone number 761 782 9100.

Stamp of the business. Delivery date:

